

Structural Connections
Utility Connections

Leviat®
A CRH COMPANY

MB Bowco Product Guide

Precision molded infrastructure accessories



Imagine. Model. Make.

We imagine, model and make engineered products and innovative construction solutions that help turn architectural visions into reality and enable our construction partners to build better, safer, stronger and faster.

Our areas of expertise:

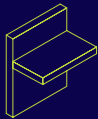

Structural Connections

Systems to form robust, efficient connections, and continuity of concrete reinforcement as necessary, between walls, slabs, columns, beams and balconies, providing structural integrity as well as enhanced thermal and acoustic performance.

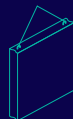

Lifting & Bracing

Systems for the safe and efficient transportation, lifting and temporary bracing of cast concrete elements and tilt-up panels before permanent structural connections are made.

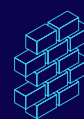

Façade Support & Restraint

Systems for the safe and thermally-efficient fixing of the external building envelope, including brick and natural stone, insulated sandwich panels, curtain walling and suspended concrete façades, and also the repair and strengthening of existing masonry installations.

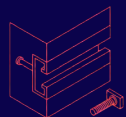

Anchoring & Fixing

Systems for fixing secondary fixtures to concrete, including anchor channels, bolts and inserts; also tension rod systems for roofs and canopies.



Formwork & Site Accessories

Non-structural accessories that complement our engineered solutions and help keep your construction environment operating safely and efficiently, including molds for casting standard and special concrete elements and construction essentials such as reinforcing bar spacers.

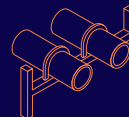

Industrial Technology

Mounting channels, pipe clamps and other versatile framing systems that provide safe fixing in a wide range of industrial applications.

Leviat product ranges:

Ancon | Aschwanden | Connolly | Halfen | Helifix | Isedio | Meadow Burke | Modersohn | Moment | Plaka | Scaldex | Thermomass

MB Bowco Product Guide

Contents

Utility Connections	4
MB Bowco Duct Terminator	5
MB Bowco Manhole Step	8
MB Bowco Threaded Insert	10
MB Bowco Pulling Iron	12
MB Bowco Sump Pan	14
MB Bowco Pipe Seal	16
MB Bowco Septic Filter	17
MB Bowco Tank Coupler	18
MB Bowco Sight Glass & Ring	19
MB Bowco Tube Channel	20
MB Bowco Pole Cap	21

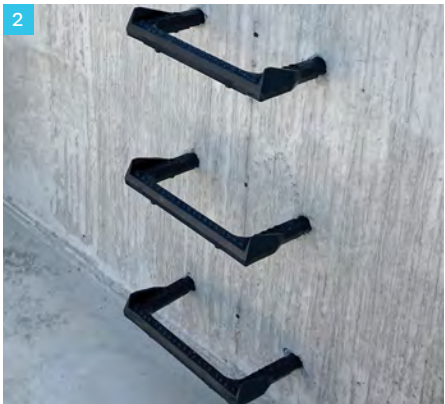
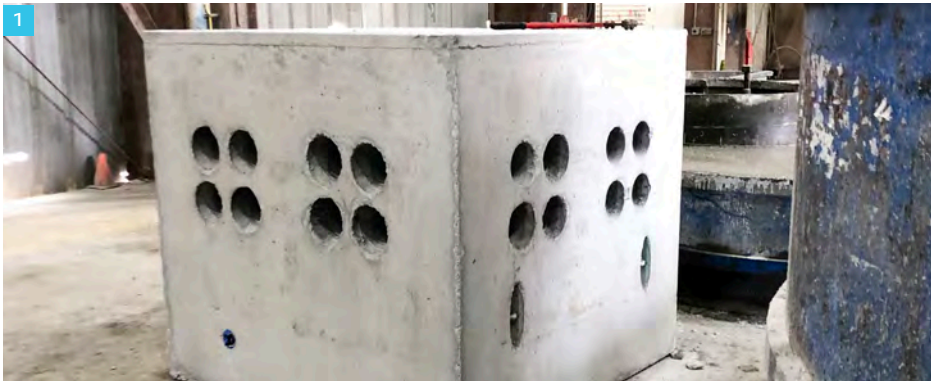

1 Utility Connections

2 MB Bowco Manhole Steps

3 MB Bowco Duct Terminator

4 MB Bowco Sump Pan

Industry Leadership

Leviat is proud to be a member of a number of leading precast industry associations, including:



Utility Connections

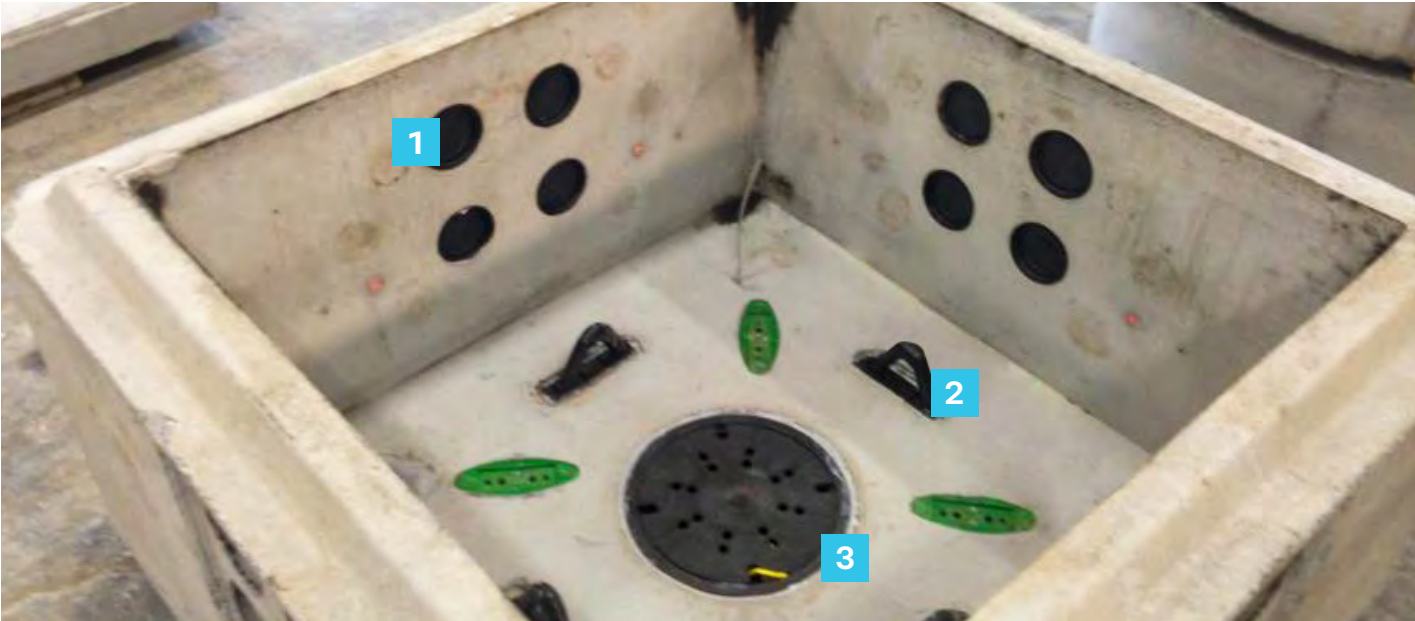

1 MB Bowco Duct Terminator

2 MB Bowco Pulling Irons

3 MB Bowco Sump Pan

Modern infrastructure depends on a variety of services supplied via underground systems to ensure efficient operations, adequate protection and minimal visual impact.

In turn, those systems carrying water, electrical, sewer, internet and telecom service to millions of homes and business rely extensively on precast concrete elements in the

form of vaults, culverts, and concrete pipes.

Creating robust, durable and easy-to-use accessories for these normally massive concrete units takes engineering innovation, attention to detail and a focus on safety that only a company like Leviat can supply.

From manhole steps to duct terminators, and threaded

connection inserts to septic filters; Leviat offers a complete portfolio of high-performance, corrosion-resistant solutions that not only enhance the durability and reliability of underground utility networks but also improve the safety of workers and expedite construction processes, ensuring long-term uninterrupted service for businesses and communities.

Leviat Offers...

Trusted, made-in-America products featuring decades of quality, reliability and performance.

A team of industry experts in utility precast product design, engineering, and manufacturing.

A culture of constant innovation that fosters engineered solutions for projects of any size or complexity.

MB Bowco Duct Terminator

Precision Utility Precast Connections

Overview

MB Bowco Duct Terminators play a vital role in connecting PVC electrical ducts with a secure and watertight seal within precast concrete structures. Leviat offers precision-manufactured terminators in a range of sizes to cater to your specific requirements.

For wider precast manholes and vaults, Leviat offers pre-assembled extended terminators. Terminator locators are also available for locating duct terminators in concrete vault walls.

When casting thicker walls or larger panel dimensions, MB Bowco Duct Terminators can be expertly assembled into brackets, creating custom panels. This service streamlines the manufacturing process, reducing labor requirements at the plant.

Leviat's custom panel system is available for most standard sizes, providing versatility to accommodate various configurations.

Features

- **Easy Installation:** Also available is a terminator bracket, specifically engineered to position terminators at 6" or 8" center-to-center intervals for special or custom applications.
- **Concrete Protection:** All sizes are available with a flexible seal ring designed to serve two important functions:
 - Prevent concrete from infiltrating the terminator opening during casting
 - Provide a smooth edge for seamless cable pulling operations, ensuring ease and efficiency



MB Bowco Duct Terminator

Precision Utility Precast Connections

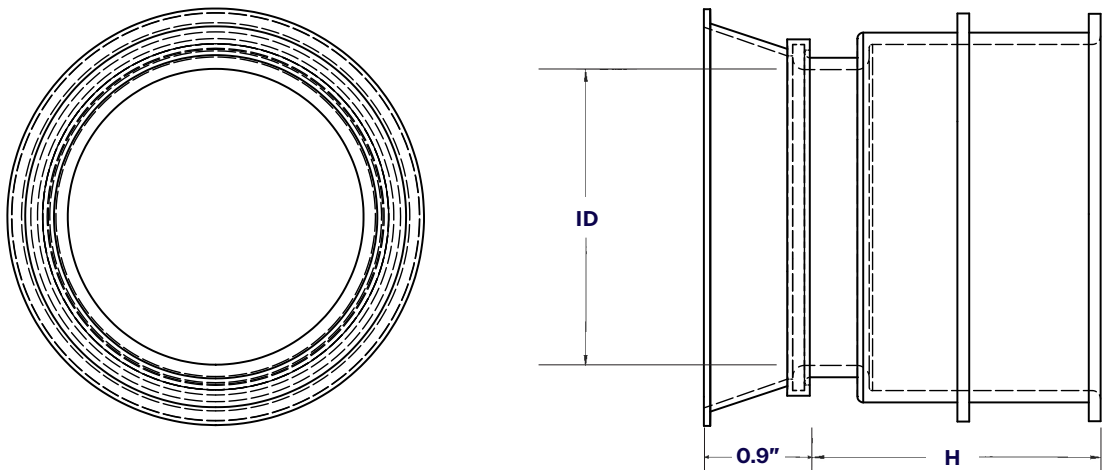

Product Data - MB Bowco Duct Terminator

Item Number	ID - Inside Diameter	H - Height	SCH 80	SCH 80 Outside Diameter	SCH 40	SCH 40 Outside Diameter	SCH 32.5	SCH 32.5 Outside Diameter
T2000	2.38"	2.39"	2	2.375"	2	2.375"	2	2.303"
T2001	2.38"	3.45"	2	2.375"	2	2.375"	-	-
T2534	2.4"	5.5"	2	2.375"	2	2.375"	-	-
T3000	3.51"	3"	3	3.5"	3	3.5"	3	3.388"
T3001	3.51"	3.43"	3	3.5"	3	3.5"	-	-
T3534	3.52"	5.5"	3	3.5"	3	3.5"	-	-
T4350	4.36"	3.43"	-	-	-	-	-	-
T4000	4.51"	3"	4	4.5"	4	4.5"	4	4.358"
T4501	4.51"	3.43"	4	4.5"	4	4.5"	-	-
T4504	4.51"	2.5"	4	4.5"	4	4.5"	-	-
T4534	4.51"	5.5"	4	4.5"	4	4.5"	-	-
T5000	5.57"	2.22"	5	5.563"	5	5.63"	5	5.391"
T5001	5.57"	3.43"	5	5.563"	5	5.63"	-	-
T5534	5.57"	5.64"	5	5.563"	5	5.63"	-	-
T5434	5.57"	4.5"	5	5.563"	5	5.63"	-	-
T6000	6.63"	3.43"	6	6.625"	6	6.25"	6	6.424"
T6534	6.64"	5.5"	6	6.625"	6	6.25"	-	-
T6734	6.64"	7.5"	6	6.625"	6	6.25"	-	-
*T8000	8.63"	5.75"	7	8.625	7	8.625"	7	8.355"

* Seal ring not included

Product Data - STD Terminators for 4" Wall

Item Number	ID - Inside Diameter	Packaging
BC101190	T2000 w/S2 2" Duct Terminator w/ Seal Ring	140/BX
BC101210	T2001 w/S2 2" Duct Term w/Seal Ring	105/BX
BC101240	T3000 w/S3 3" Duct Term w/Seal Ring	126/BX
BC101270	T3001 w/S3 3" Duct Term w/Seal Ring	126/BX
BC101300	T4000 4" Duct Terminator w/Hard Seal Ring	72/BX
BC101310	T4000 4" Duct Terminator w/Seal Ring	80/BX
BC101330	T4350 w/S4 4.35" Duct Term w/Seal Ring	90/BX
BC100070	4.35/4.5" Term-A-Duct w/SR	90/BX
BC101380	T4351 w/S4 4.35/4.5" Duct Term w/ Seal Ring	90/BX
BC101430	T4351HD w/S4 4.35/4.5" Duct Term w/SR	90/BX
BC101490	T4501 w/S4 4.5" Duct Terminator w/ SR	90/BX
BC101550	T4501HD w/S4 4.5" Duct Term w/ Seal Ring	90/BX
BC101610	T5001 w/S5 5" Duct Terminator w/ Seal Ring	50/BX
BC100160	5" Term-A-Duct w/Membrane Seal Ring	50/BX
BC101630	T6000 w/S6 6" Duct Terminator w/ Seal Ring	40/BX
BC101640	T8000 8" Duct Terminator	-
BC100120	DB2 107 mm Term-A-Duct w/ Seal Ring	-

Product Data - Extended Terminators (molded)

Item Number	ID - Inside Diameter	Packaging
BC100490	T2534 2" Duct Term w/SR for 6" Wall	75/BX
BC100580	T3534 w/S3 3" Duct Term w/SR for 6" Wall	84/BX
BC100790	T4534 w/S4 4.5" Duct Term w/SR for 6" Wall	60/BX
*BC10090	T5534 w/S5 5" Duct Term w/SR NBKT 6" Wall	40/BX
*BC101040	T6534 w/S6 6" Duct Term w/SR NBKT 6" Wall	28/BX

* NOT BRACKET COMPATIBLE

Product Data - Extended Terminators (assembled)

Item Number	ID - Inside Diameter	Packaging
BC100480	T2434 2" Duct Term w/SR for 5" Wall	105/BX
BC100500	T2634 2" Duct Term w/SR for 7" Wall	-
BC100520	T2734 2" Duct Term w/SR for 8" Wall	50/BX
BC100530	T2834 2" Duct Terminator w/Seal Ring for 9" Wall	-
BC100540	T2934 w/S2 2" Duct Term w/SR for 10" Wall	45/BX
BC100450	T21134 2" Duct Term w/SR for 12" Wall	35/BX
BC100545	T2534 2" Duct Term w/SR for 19" Wall	-
BC100570	T3434 w/S3 3" Duct Term w/SR for 5" Wall	90/BX
BC100620	T3734 w/S3 3" Duct Terminator w/Seal Ring for 8" Wall	-
BC100630	T3834 w/S3 3" Duct Terminator w/Seal Ring for 9" Wall	-
BC100640	T3934 w/S3 3" Duct Terminator w/Seal Ring for 10" Wall	-
BC100560	T31134 w/S3 3" Duct Terminator w/Seal Ring for 12" Wall	-
BC100750	T4434 w/S4 4.5" Duct Term w/SR for 5" Wall	60/BX
BC100800	T4634 w/S4 4.5" Duct Terminator w/Seal Ring for 7" Wall	-
BC100830	T4734 w/S4 4.5" Duct Term w/SR for 8" Wall	48/BX
BC100840	T4834 w/S4 4.5" Duct Term w/SR for 9" Wall	42/BX
BC100850	T4934 w/S4 4.5" Duct Terminator w/Seal Ring for 10" Wall	-
BC100660	T41134 w/S4 4" Duct Term w/SR for 12" Wall	30/BX
BC100880	T5434 w/S5 5" Duct Term w/SR for 5" Wall	40/BX
BC100900B	T5534 w/S5 5" Duct Term w/SR for 6" Wall Bracket Compatible	-
BC100960	T5734 w/S5 5" Duct Term w/SR for 8" Wall	30/BX
BC100980	T5934 w/S5 5" Duct Term w/SR for 10" Wall	24/BX
BC100865	5" Terminator w/Seal Ring for 12" Wall w/PVC Pipe	-
BC101010	T6434 w/S6 6" Duct Term w/SR for 5" Wall	35/BX
BC101040B	T6534 w/S6 6" Duct Term w/SR for 6" Wall Bracket Compatible	-
BC101045	T6634 w/S6 6" Duct Term w/SR for 7" Wall	24/BX
BC101070	T6734 w/S6 6" Duct Term w/SR for 8" Wall	21/BX
BC101080	T6834 w/S6 6" Duct Term w/SR for 9" Wall	18/BX
BC101090	T6934 w/S6 6" Duct Term w/SR for 10" Wall	18/BX
BC101000	T61134 w/S6 6" Duct Term w/SR for 12" Wall	14/BX
BC101670	T8X12 8" Duct Terminator for 12" Wall	-
BC101710	T8X8 8" Duct Terminator for 8" Wall	-
BC101720	T8X9 8" Duct Terminator for 9" Wall	-

MB Bowco Manhole Step

Safe, Durable Underground Access

Overview

MB Bowco Manhole Steps feature injection-molded, copolymer polypropylene coated Grade 60, ½" rebar, for durable, corrosion-resistant, long-lasting access underground sewer and utility structures.

Updated Design: 10" MB Bowco Manhole Steps are double-faced for installation in either orientation.



Features

- **Strong:** Minimum pullout strength of 400lbs, in accordance with ASTM C-497. Withstands vertical loads of 800lbs, satisfying ASTM C-478
- **Easy Installation** using sockets and locator accessories, available separately
- **Established:** DOT approved in over 30 states under the Bowco product name
- **Durable:** Copolymer polypropylene coating provides corrosion resistance and ensures the manhole steps will exceed the useful life of the utility structure
 - Copolymer polypropylene conforms to ASTM D-41 01 under Type 2
 - Grade 60, ½" rebar meets ASTM A-615
- **Approved:** Conforms to AASHTO M 199M/M Standard Specification for Precast Reinforced Concrete Manhole Sections. Designed to meet OSHA STD 1910.24 (b).
- **Options:** Available in black or orange, in 10" (double-faced) and 13" widths, and in 8 ½" and 9 ⅜" step depths
- **Safe:** Durable, non-slip surface



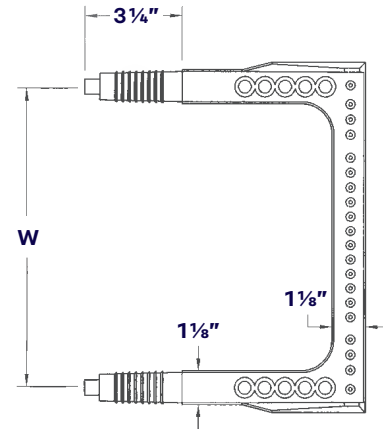
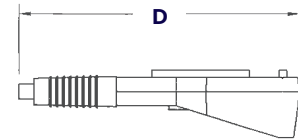

Product Data - MB Bowco Manhole Step

Item Number	Description	W	D	Packaging
BC110030	81213-R Black Step	13"	8 1/2"	25 / box 600 / plt
BC110040	81213-R Orange Step	13"	8 1/2"	25 / box 600 / plt
BC110140	93810-R Black Step Double-Faced	10"	9 3/8"	25 / box 700 / plt
BC110150	93810-R Orange Step Double-Faced	10"	9 3/8"	25 / box 700 / plt
BC110220	93813-R Black Step	13"	9 3/8"	25 / box 600 / plt
BC110240	93813-R Orange Step	13"	9 3/8"	25 / box 600 / plt



SP Socket

- Works well with Dry Cast applications
- Excellent for vacuum testing
- Use removable pin to hold in place



OR Socket

- Works well with flat or round wall structures – Wet or Dry Cast
- Mounts to wood or steel forms using threaded holes in closed end

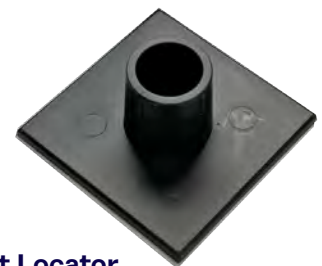

Socket Locator

- The SPSL-1 manhole step socket locator helps secure proper placement of the manhole step socket prior to concrete pouring

Product Data - MB Bowco Manhole Step Accessories

Item Number	Description	Packaging
BC110390	SP Socket	400 / box
BC110340	OR Socket	420 / box 10,080 / plt
BC110410	SPSL-1 Socket Locator - Stick On	250 / box
BC110380	Sizing Pin	200 / box



Sizing Pin

- Used to easily create installation locations

MB Bowco Insert Locator

Cost-Effective Concrete Fastening

Overview

MB Bowco Polymer Threaded Inserts are a simple, strong and cost-effective method for anchoring railings, frames and similar fixtures to precast or cast-in-place concrete units. Available locator accessories apply easily to wood or metal forms to aid precision insert placement.

Light-weight and easy-to-install, Polymer Threaded Inserts will not corrode or rust and offer a clean, unobtrusive bolted connection point for post-installed hardware and equipment on almost any concrete surface.

Features

- **Easy Installation:** Polymer Threaded Inserts install quickly, especially when used in conjunction with Press-In, Tap-On, or Stick-On MB Bowco Insert Locators



- **Versatile:** Ideal for a variety of uses, including:

- Bolting equipment, racking or channels to vault walls
- Securing HVAC units and other equipment to concrete pads
- Bolting metal or cast-iron frames to concrete lids
- Suspending pipes and conduit from concrete panels
- Attaching handrails and railing posts

- **Reliable:** Superior mechanical strength and corrosion resistance for dependable, long-term performance

- **Lightweight:** Polymer Threaded Inserts are easy to handle and install

- **Convenient Sizes:** Available in various bolt diameters ranging from 1/4" to 3/4"



Product Data - MB Bowco Polymer Threaded Insert

Item Number	Bolt Diameter	NC Threaded	A	B	C	SWL	Packaging
BC140180	1/4"	20	0.75"	1"	1.5"	1,000 lbs	1,400 / box
BC140220	3/8"	16	0.75"	1"	1.5"	1,000 lbs	1,400 / box
BC140110	1/2"	13	0.75"	1.25"	1.5"	1,000 lbs	850 / box
BC140150	1/2"	13	0.75"	1.25"	1.75"	1,200 lbs	700 / box
BC140130	1/2"	13	0.75"	1.25"	2.5"	2,500 lbs	500 / box
BC140120	1/2"	13	0.75"	1.25"	3.25"	2,500 lbs	400 / box
BC140200	3/4"	10	1"	1.63"	3.2"	3,000 lbs	225 / box
BC140240	5/8"	11	0.95"	1.38"	2.95"	3,000 lbs	300 / box

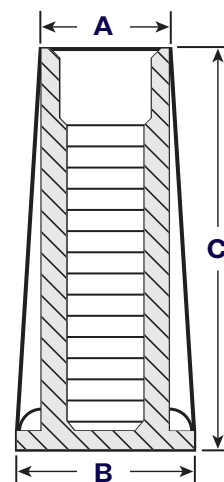

Product Data - MB Bowco Threaded Insert Locator

Item Number	Description	Insert Diameter	Packaging
BC140260	PI12X38 Insert Locator-Press In 3/8" Hole	1/2"	1,500 / box
BC140280	PI12X58 Insert Locator-Press In 5/8" Hole	1/2"	1,500 / box
BC140290	PI12X58S Short Locator-Press In 5/8" Hole	1/2"	2,000 / box
BC140330	PI38X38 Insert Locator-Press In 3/8" Hole	3/8"	2,500 / box
BC140350	PI58X58 Locator 5/8" Hole	5/8"	900 / box
BC140370	SO12 Insert Locator - Stick On	1/2"	250 / box
BC140400	SO12ESPC Insert Locator - Stick On	1/2"	500 / box
BC140420	SO12SA Short Stick On Threaded Insert Locator	1/2"	500 / box
BC140440	SO14 Insert Locator - Stick On	1/4"	350 / box
BC140450	SO34 Insert Locator - Stick On	3/4"	200 / box
BC140460	SO38 Insert Locator - Stick On	3/8"	250 / box
BC140470	SO58 Insert Locator - Stick On	5/8"	250 / box
BC140490	TO12 Insert Locator - Tap On with 3/16" Hole	1/2"	Call
BC140500	TO12 Insert Locator - Tap On with 1/4" Hole	1/2"	Call



Press-In Locator



Stick-On Locator



Tap-On Locator

MB Bowco Pulling Iron

Durable Anchorage for Cable Installation

Overview

MB Bowco Pulling Irons are available in a variety of configurations, including shielded cable pulling irons, patented plastic-coated pulling irons and galvanized steel pulling irons.

Void-former pockets, featuring our user-friendly patented Snap-N-Seal system, are also available. This innovative design allows the pulling iron to snap securely into place without the need for packing materials.

Features

- **Secure Installation:** Effortlessly snaps into place, ensuring a stable and secure fit
- **No Packing Required:** Eliminates the need for additional packing materials to keep the pulling iron securely in place
- **Tight Seal:** A gasket between the pulling iron and pocket creates a watertight seal, preventing concrete ingress
- **No Tape Needed:** There's no need for tape to protect against concrete infiltration
- **Cost-Effective:** No extra materials or labor are necessary to guarantee proper performance

- **Flush Fit Pocket Lid:** The pocket lid fits flush, requiring no tape or cutting for installation
- **Reusable Lid:** The pocket lid can be reused multiple times, contributing to cost savings



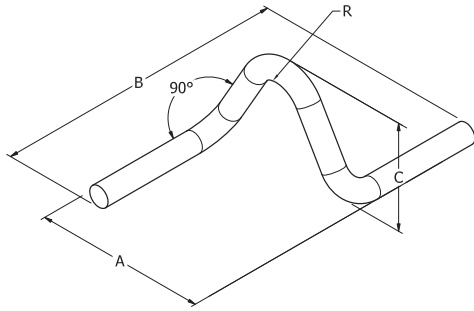

Type I

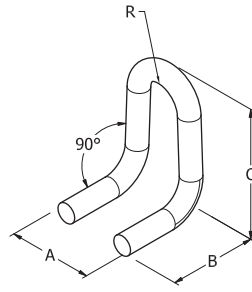

Type II

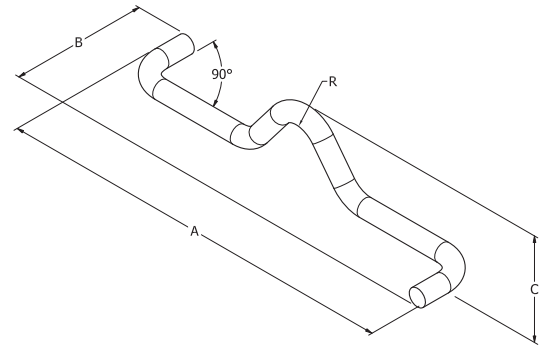

Type III

Product Data - MB Bowco Galvanized Pulling Iron

Item Number	Description	Type	A	B	C	R	Diameter
BC153345	B785573 Pulling Iron - UV CO.	II	7.6"	3.6"	5.5"	1.0"	7/8"
BC153210	B784212 Pulling Iron	I	7.0"	11.4"	4.75"	1.0"	7/8"
BC153103	B346232 Pulling Iron	II	3.25"	3.5"	5.25"	0.75"	3/4"
BC153116	B781055 Pulling Iron	II	5.5"	4.5"	10.0"	1.0"	7/8"
BC153170	B783519 Pulling Iron	III	19.0"	5.63"	3.5"	1.0"	7/8"
BC153360	B786010 Pulling Iron	I	6.5"	12.0"	7.0"	1.0"	7/8"

Cable Pulling Iron

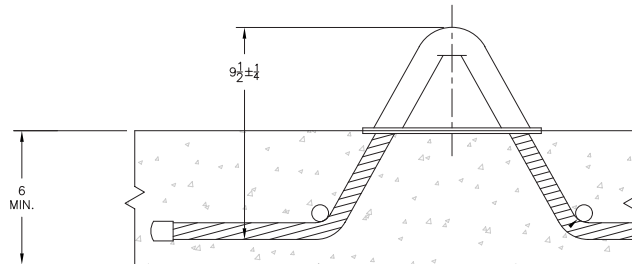

Product Data - MB Bowco Cable Pulling Iron and Pocket

Item Number	Description	Packaging
BC150000	BPI-1 Plastic Coated Pulling Iron	300 / plt
BC150020	BPIL-1 Pulling Iron Pocket Lid	150 / box 1,800 / plt
BC150030	BPIL-01 Pulling Iron Pocket	100 / box 1,200 / plt
BC150070	BPIL-05 Pocket for 3/4" Bar for B342519	Call
BC150090	BPIL-06 Pocket for B783717	Call

Pocket



Lid



MB Bowco Sump Pan

Durable, Reliable Drainage Enclosure

Overview

MB Bowco Sump Pans are designed for convenience, reliability and long-term performance.

Manufactured from high-strength plastic, MB Bowco Sump Pans are an ideal solution for creating sturdy, precise egress points that allow water drainage from utility boxes, communication enclosures, vaults, and other precast concrete elements.



Features

- **Durable:** Crafted from corrosion-free materials, ensuring longevity and durability.
- **Ease of Handling:** Lightweight construction makes it easy to handle and install.
- **Secure Lid:** Available for purchase separately, the sump pan lid is engineered to be heavier than water, preventing it from floating. It is attached with a durable plastic tether for added security.
- **Versatile:** Convenient size and durable construction make MB Bowco Sump Pans a good choice for any number of applications.

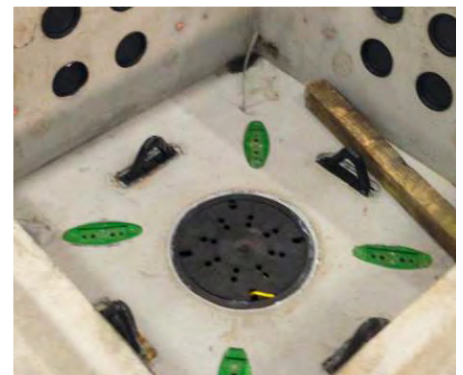

Lid

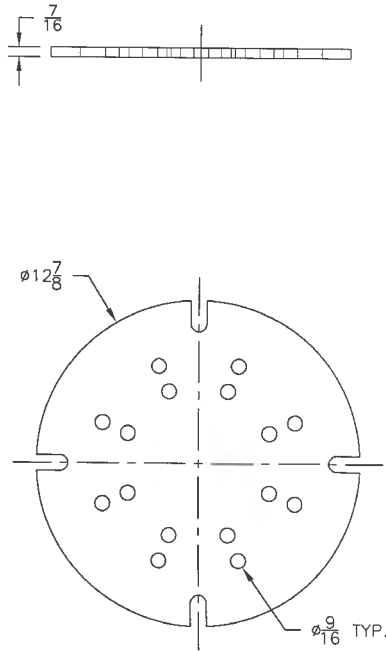

Sump Base

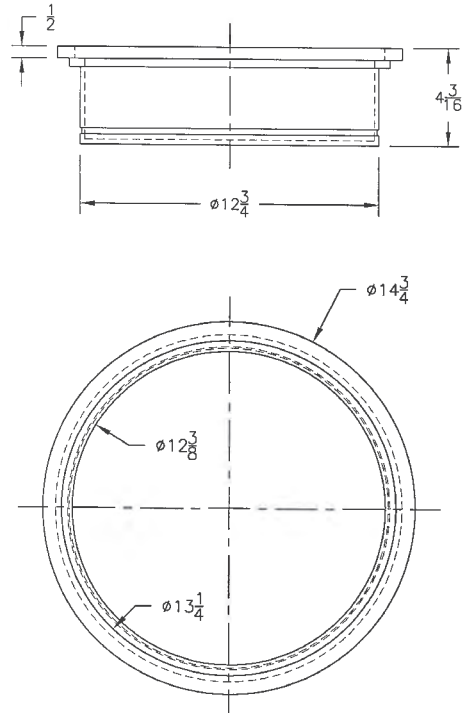

Product Data - MB Bowco Sump Pan

Item Number	Description	Packaging
BC150100	BSP-1 Sump Pan	Call
BC150110	BSP-12 Sump Pan w/ Lid - 12" Deep	Call
BC150120	BSP-2 Sump Pan w/ Lid - 4" Deep	48 / plt
BC150125	BSP-2WO Sump Pan with Lid-No Bottom - 4" Deep	Call
BC150130	BSP-8 Sump Pan with Lid - 8" Deep	Call
BC150150	BSPL-1 Sump Pan Lid	300 / bucket

MB Bowco Pipe Seal

Watertight Pipe Capping

Overview

MB Bowco Pipe Seals are easy to install and remove. They are designed to fit a variety of pipe ends, allowing for maximum flexibility.

Pipe Seals cap unfinished openings and provide for future expansion or service access while preventing damage from moisture, debris and other elements.

Features

- **Versatile:** Accommodates 4" SDR 35 pipe (HD35), 4" SCH 40 pipe (HD40), or 2" to 4" SCH 40 Pipe (LD-1)
- **Simple Installation:** Eliminates the need for grouting, saving time
- **Easy Conversion:** Mounts seamlessly onto existing locators
- **Strong:** Ensures watertight seal capable of withstanding over 20 inches of mercury vacuum (10 PSI)
- **Durable:** Crafted from corrosion-free materials, ensuring longevity and durability
- **Ease of Handling:** Lightweight construction allows for simple handling and installation

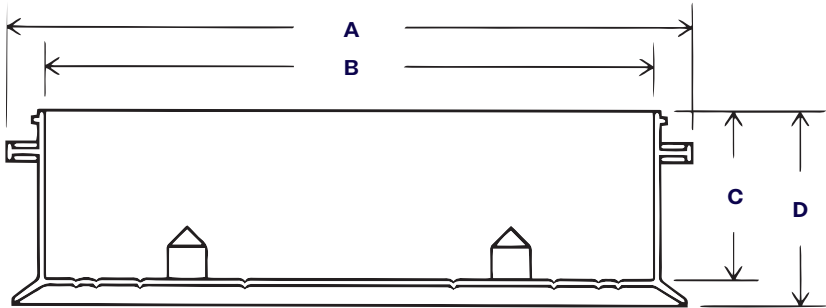

Product Data - MB Bowco Pipe Seal

Item Number	Description	A	B	C	D	Packaging
BC146000	POLY-SEAL HD35	5.5"	4.85"	1.42"	1.67"	170 / box
BC146010	POLY-SEAL HD40	5.5"	4.85"	1.51"	1.67"	170 / box
BC147000	POLY-SEAL LD1	5.5"	4.85"	1.42"	1.67"	170 / box 2,040 / plt

MB Bowco Septic Filter

Simple, Effective Outlet Filtering

Overview

With over 235 feet of filtration, the MB Bowco EF-235 Septic Filter provides a simple, efficient solution for extending the life of the drain field by preventing suspended solids larger than 1/16" from leaving the septic tank. The filter extends below the scum line yet stays above the sludge layer, withdrawing effluent from the clear water zone of the tank.

Located in the outlet tee, the filter is rated for 1,500 gallons per day and is suitable for use in residential and light commercial applications.

Features

- **Versatile:** Fits inside any 4" outlet tee for new or retrofit applications
- **Easy-to-Use:** Equipped with a 1/2" threaded insert to connect a detachable extension handle to ease in the installation and removal of filter. Unique 360-degree outflow design eliminates potential installation problems
- **Durable:** Manufactured using long-lasting, non-corrosive, virgin polymers



Product Data - MB Bowco Septic Filter

Item Number	Description	Packaging
BC156020	EF-235 Effluent Septic Filter Cartridge	25 / box

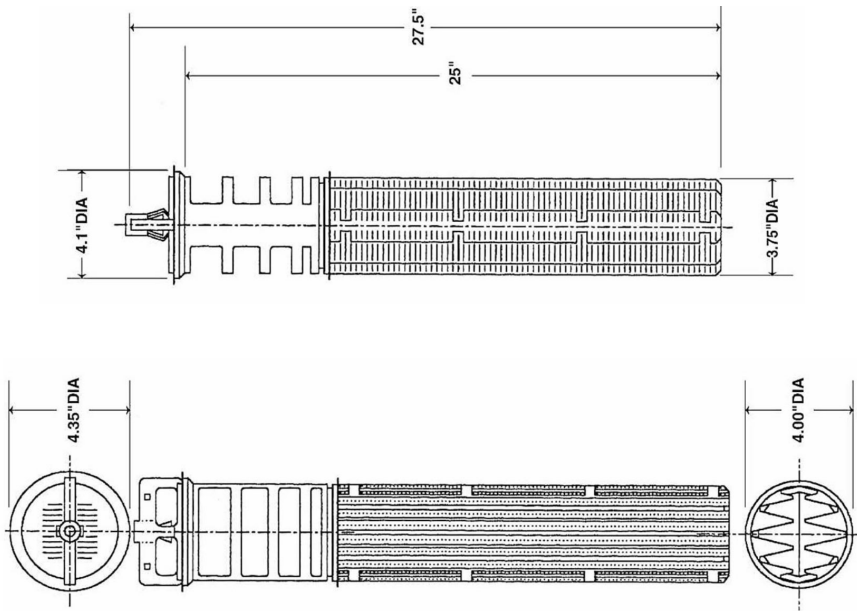

MB Bowco Tank Coupler

Internally Connect Pipe

Overview

The MB Bowco 4" tank couplers are used to internally connect pipe and are available for both SDR35 and SCH40 pipe and.

Features

- **Durable:** Couplers are made out of high impact polystyrene.

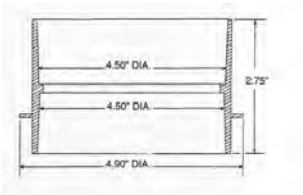
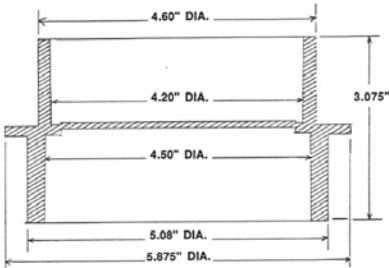
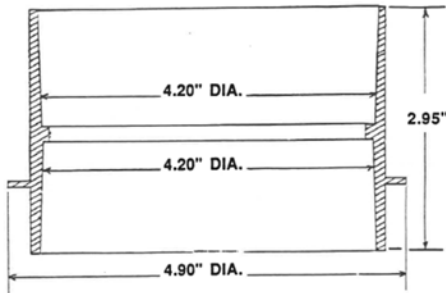

Product Data - MB Bowco Tank Coupler

Item Number	Description	Packaging
BC100220	C3535 Coupler	120 / box
BC100250	C4035M Coupler Grey	45 / box
BC100270	C4040S Coupler Black	138 / box

MB Bowco Sight Glass & Ring

Quickly Read or View Meter Level

Overview

MB Bowco Sight Glass is threaded to securely install with the Sight Glass Ring for a watertight seal and made from durable and crystal-clear acrylic plastic. Sight glass is 2 ¼" in diameter and is about ¾" tall.

Features

- **Durable:** MB Bowco Sight Glass Ring is made from high impact polystyrene. Seal ring is 2 ½" in diameter.
- **Easy to Use:** MB Bowco Sight Glass provides a quick way to measure or read a meter through polymer panels and utility boxes.

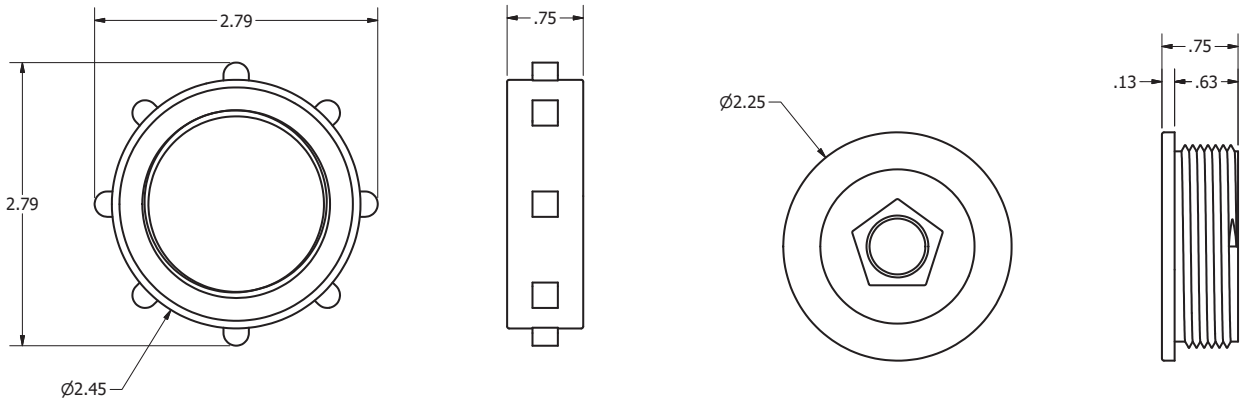

Product Data - MB Bowco Sight Glass & Ring

Item Number	Description	Packaging
BC103530	Sight Glass	250 / box
BC103540	Sight Glass Ring	250 / box

MB Bowco Tube Channel

Pneumatic Hose Organization

Overview

The MB BowcoTube Channels provide installers with a simple way of organizing and securing plastic tubing. When Tube Channels are use, future troubleshooting and repairs are conducted in an easier fashion.

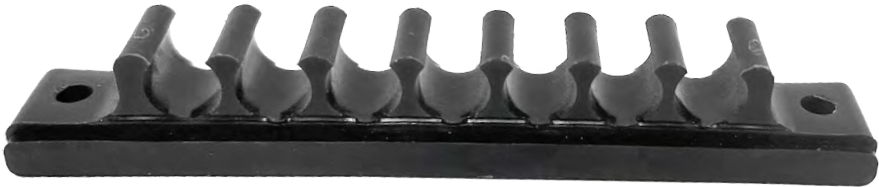

Features

- **Versatile:** MB Bowco Tube Channels are perfect for securing up to 7, 3/8" (OD) tubes, providing a solution for versatile tube management.
- **Easy Installation:** Tube channels provide installers a convenient solution for securing and organizing plastic tubing effectively.
- **Versatile:** Future troubleshooting or tube re-routing is effortlessly facilitated with the MB Bowco Tube Channel, allowing for seamless maintenance and modifications.

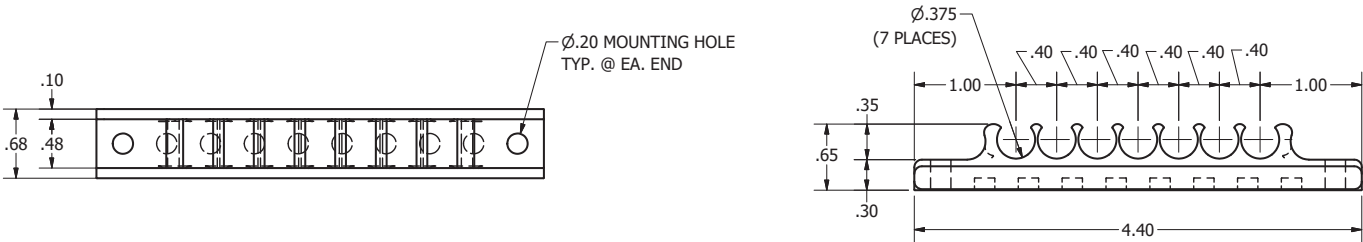

Product Data - MB Bowco Tube Channel

Item Number	Description	Packaging
BC130130	PTC6-7 Plastic Tube Channel(7)for 3/8 OD	1,000 / box

MB Bowco Pole Cap

Durable Utility Pole Top Protection

Overview

MB Bowco Pole Caps are made from Low-Density Polyethylene (LLDPE) and feature 4 pre-marked nail holes for easy and quick installation.

Pole caps ship with 4 16d 3 1/2" HDG Nails.

Features

Weather Resistant: MB Bowco Pole Caps serve as a robust shield, effectively safeguarding against moisture and environmental factors, preserving the structural integrity of the utility pole.

- Durable:** Manufactured from LLDPE, MB Bowco Pole Caps are highly resistant to UV degradation and weathering.
- Easy Installation:** These pole caps offer enduring protection while ensuring easy installation using the provided HDG nails.

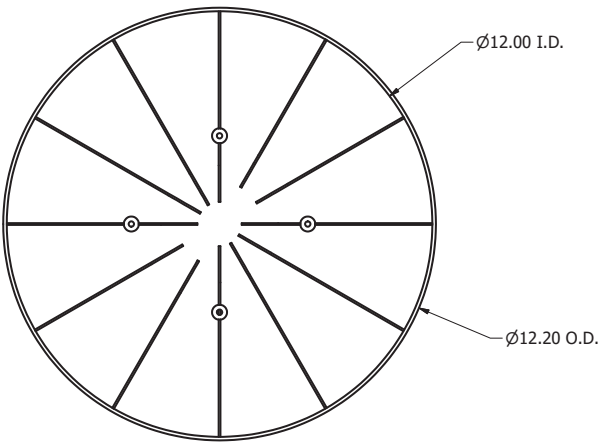
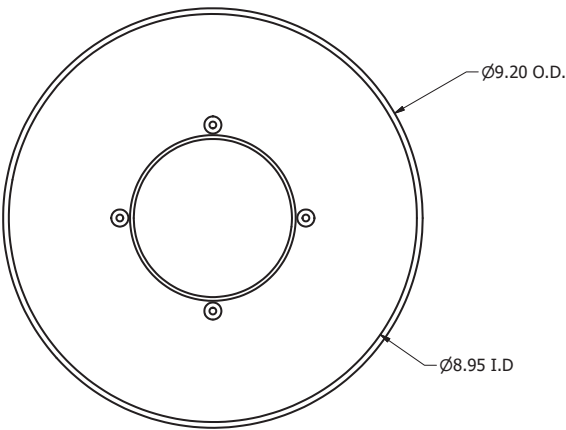

Product Data - MB Bowco Pole Cap

Item Number	Description	Packaging
BC130000	12" Pole Cap Black	25 / box
BC130020	9 1/2" Pole Cap Black	25 / box



Leviat®

Innovative engineered products
and construction solutions that
allow the industry to build safer,
stronger and faster.



North American Locations

California

3611 E La Palma Ave
Anaheim CA 92806
(800) 804-6565

Iowa

1000 Technology Drive
Boone IA 50036
(800) 232-1748

Pennsylvania

565 Oak Ridge Road
Hazle Township PA 18202
(800) 550-0060

Florida Corporate
6467 S Falkenburg Road
Riverview FL 33578
(800) 282-7213

New Jersey
526 US Route 46
Teterboro NJ 07608
(800) 207-7778

Texas
7000 Will Rogers Blvd
Fort Worth TX 76140
(800) 993-9641

Georgia
3080 N Lanier Parkway
Decatur GA 30034
(800) 241-5662

Oregon
155 S Hazel Dell Way
Canby OR 97013
(888) 232-9991

Texas
8521 FM 1976
Converse TX 78109
(800) 323-6896

Contact Information

Customer Service

(877) 518-7665

Email

info@leviat.us

Engineering Support

(813) 212-5866

Web

www.leviat.com

Leviat.com

For information on certified management systems and standards see www.meadowburke.com | www.halfen.com | www.thermomass.com

Notes regarding this catalogue

© Protected by copyright. The construction applications and details provided in this publication are indicative only. In every case, project working details should be entrusted to appropriately qualified and experienced persons. Whilst every care has been exercised in the preparation of this publication to ensure that any advice, recommendations or information is accurate, no liability or responsibility of any kind is accepted by Leviat for inaccuracies or printing errors. Technical and design changes are reserved. With a policy of continuous product development, Leviat reserves the right to modify product design and specification at any time.



L222-A002